

# Pensioner's Guide to Accessing Statement of Account on Workpal

For more information on Workpal, visit: <https://help.workpal.gov.sg>

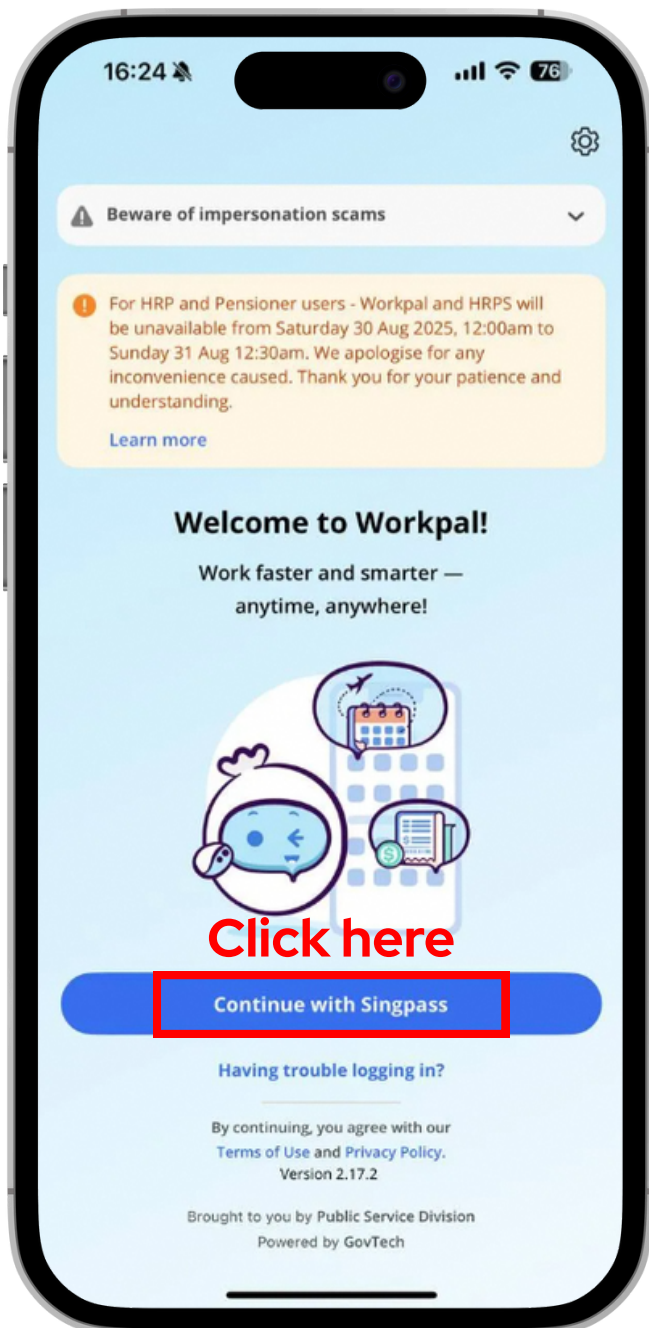

1. Launch Workpal Mobile App.



2. Log in with Singpass.



## Pensioner's Guide to Accessing Statement of Account on Workpal

For more information on Workpal, visit: <https://help.workpal.gov.sg>



3. A prompt to "Enable push notifications" will appear when users first log into Workpal.

4. Turn on notification for Workpal app on your mobile phone to receive alerts on monthly statements

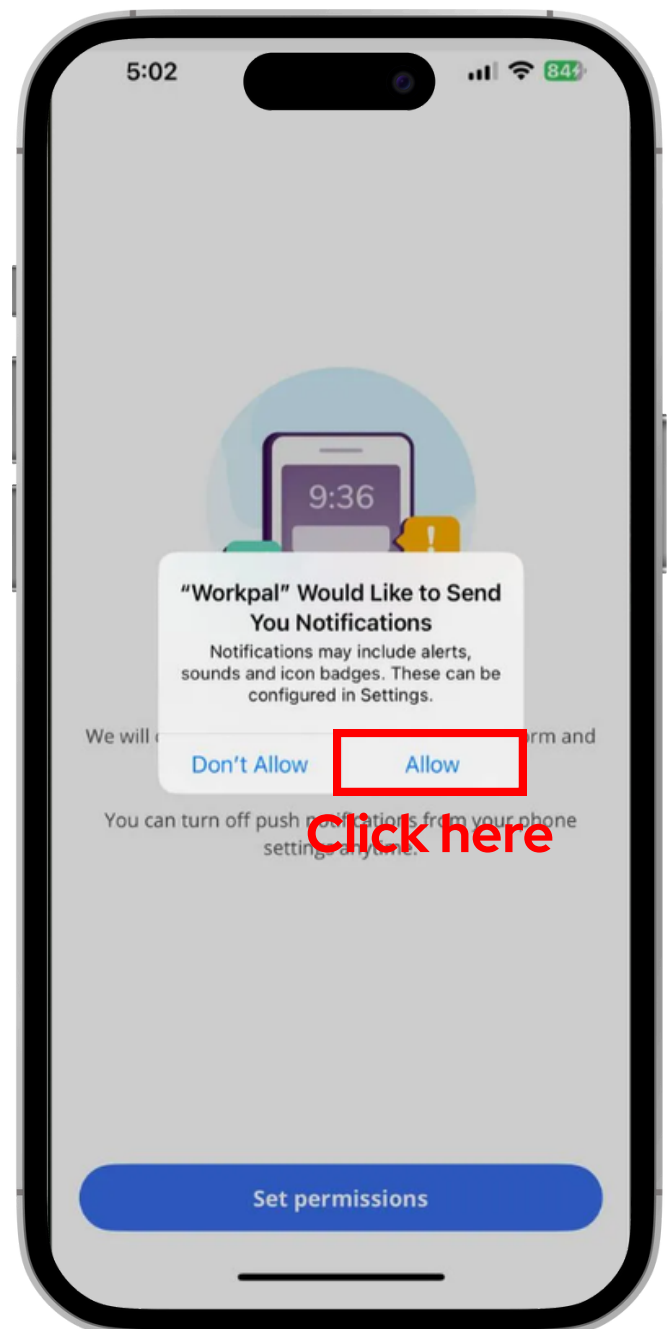
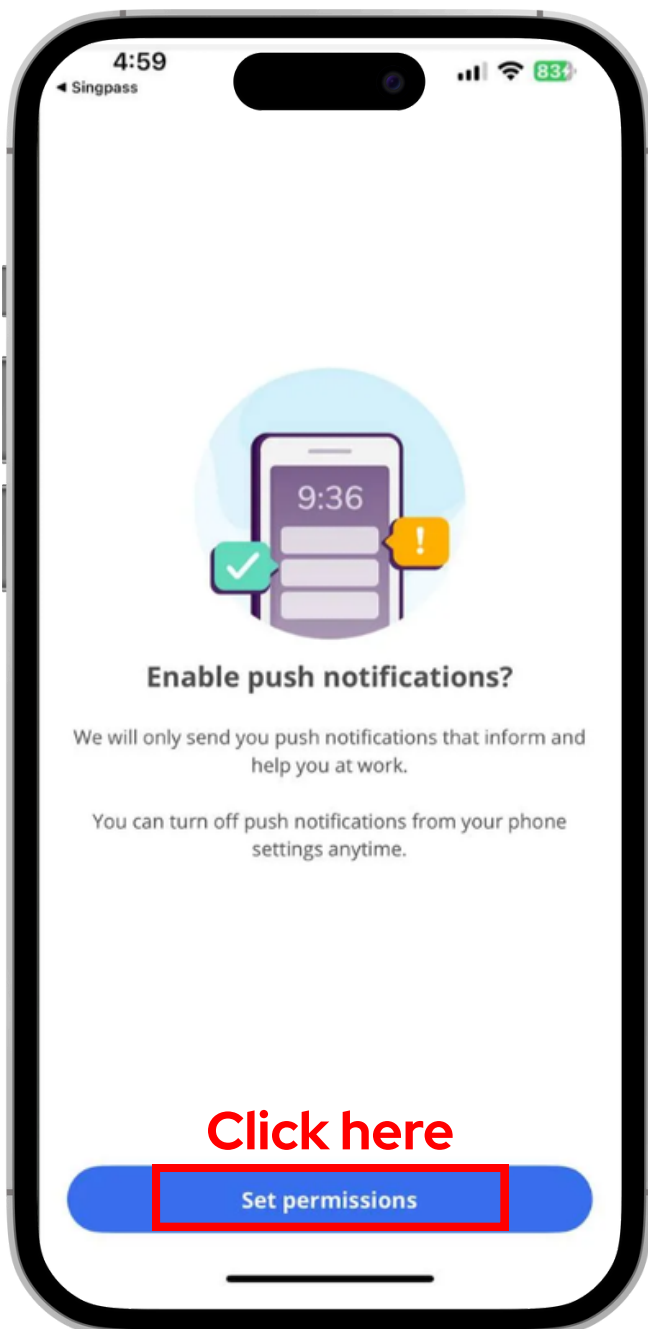

# Pensioner's Guide to Accessing Statement of Account on Workpal

For more information on Workpal, visit: <https://help.workpal.gov.sg>



5. On Main Menu, select the Statement of Accounts Tile.

6. On the Statement of Account Page, select the "Statement of Account" icon to select and view specific month's statement.

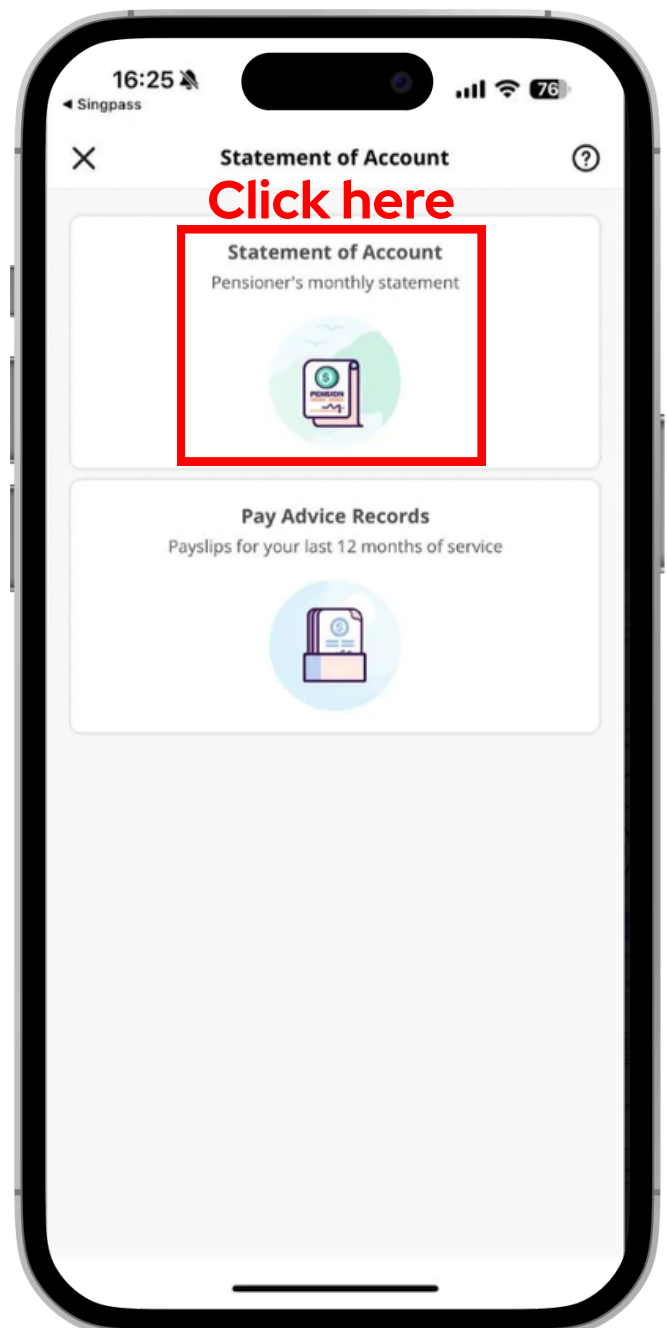
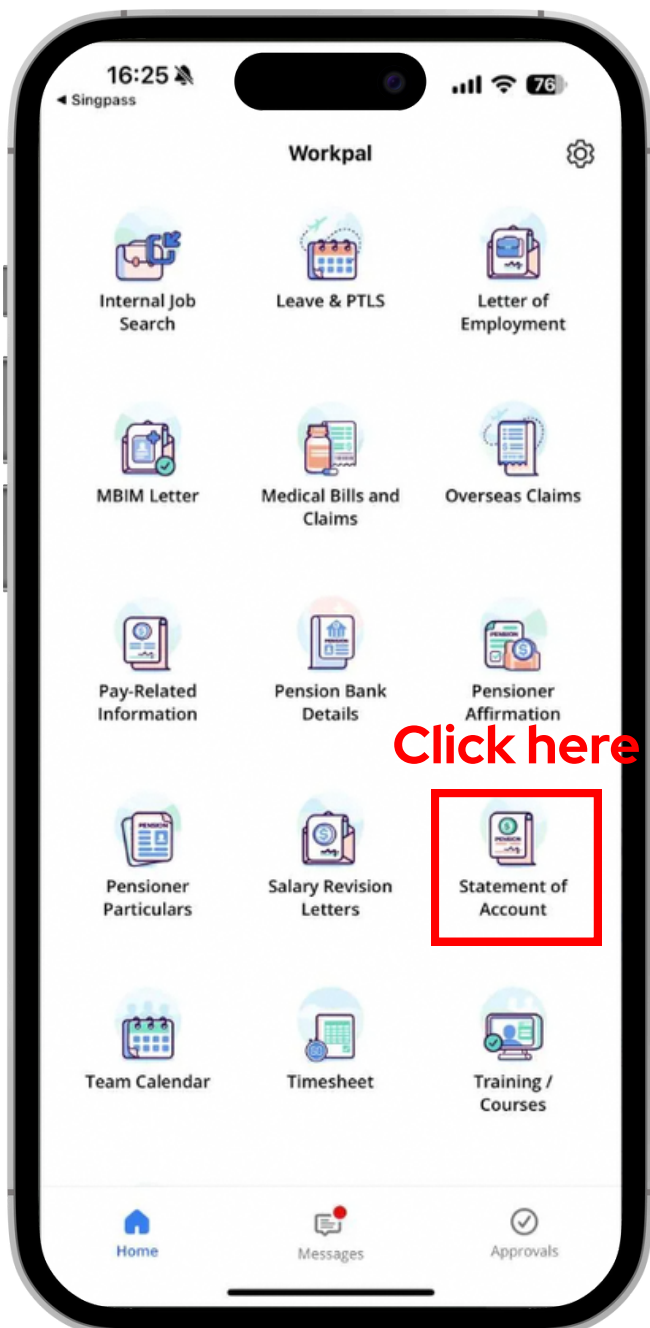

# Pensioner's Guide to Accessing Statement of Account on Workpal

For more information on Workpal, visit: <https://help.workpal.gov.sg>



7. Tap on "View PDF".

8. For iOS users, the statement will be launched in a viewer. For Android users, please select your preferred application to open the statement.

